

Luminaires with higher degree of protection

LUMEX SW



Quickinfo

LUMINAIRE

Wall and surface mounting
galvanized steel and cast iron, yellow

IP65, IK10



LED

4,000K
CRI>80
Initial MacAdam 4 SDCM
70,000h L80

LIGHT DISTRIBUTION



ELECTRIC

ON-OFF switchable



Description

The LUMEX SW is a heavy-duty explosion-proof LED luminaire optimized for longwall mining and tunneling applications in methane and coal dust hazardous atmospheres. Its compact steel and cast-iron housing with shock-resistant polycarbonate lens ensures durability and corrosion resistance under the toughest conditions.

Equipped with high-performance LEDs and asymmetrical optics, the SW delivers up to 5000 lm of uniform, glare-free illumination, perfectly suited for powered roof supports, conveyors, and underground work areas. A multifunctional service switch isolates the luminaire or the downstream line, while the integrated live phase-indicator system simplifies fault detection and enhances operational safety.

Available with clear or matt white lens (for glare reduction), and with versions covering the full mining voltage range (35–50 VAC, 100–270 VAC, 24–230 VAC). Select models feature adjustable light intensity (25–100%) for reduced power consumption and heat generation. With its robust design, wide voltage compatibility, and user-friendly installation, the LUMEX SW combines efficiency, reliability, and maximum safety in high-risk underground environments.

Types

ARTICLE NUMBER	POWER	LUMINOUS FLUX	COLOUR TEMP.	WEIGHT
EPSW045.1142Y	45W	5.000lm	4000K	12kg*

Dimensions

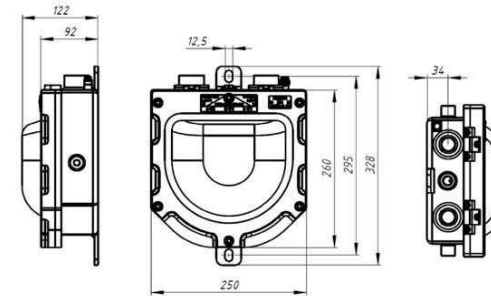

Light distribution

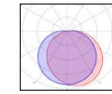

OPAL/CLEAR 130°

Additional Features

I M1 Emergency Module (on request), Light Intensity Adjustment Switch 25-50-75%

EXPLOSION PROTECTION



I M2 Ex db I Mb

Thanks to the superior impact resistance, it is particularly suitable for drill and blast tunneling. Emergency function available on request (With I M1 module)

A version for 35-50 V power supply is available. For the "standard" version the voltage range is 100V-270V AC

Light intensity adjustment switch (25%-50%-75%)

